

# SIMPL Screen

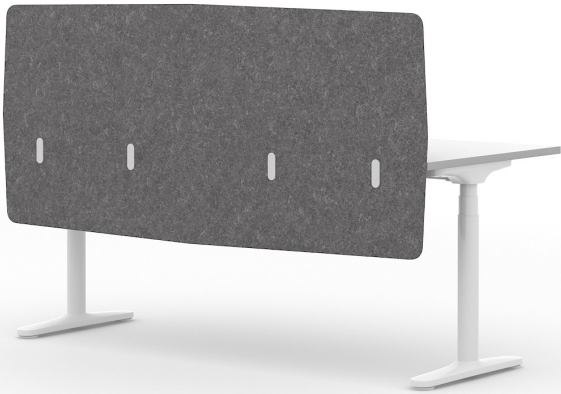

## Features:

Simpl is a frameless, lightweight screen solution that can be worktop fixed or clamped using a variety of substrates. Simpl Screen is a pinnable screen available in a range of sizes and shapes.

## Options:

- Worktop Screw-Fixed: Classic, Sweep, Elevated & Curve
- Worktop Clamp-on: Classic or Sweep

**Design:** ZENITH DESIGN STUDIO

**Warranty:** 10 years

## Finishes:

12mm Sonic Board: Zenith house range or other PET on request  
Optional 6mm acrylic substrate upon request  
Powder coated Brackets

## Sonic Board with Black Satin Bracket:

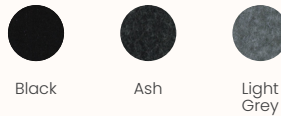

Black

Ash

Light  
Grey

## Sonic Board with White Satin Bracket:



Milky  
White

Silver

Note: Other bracket powder coat colours available on request

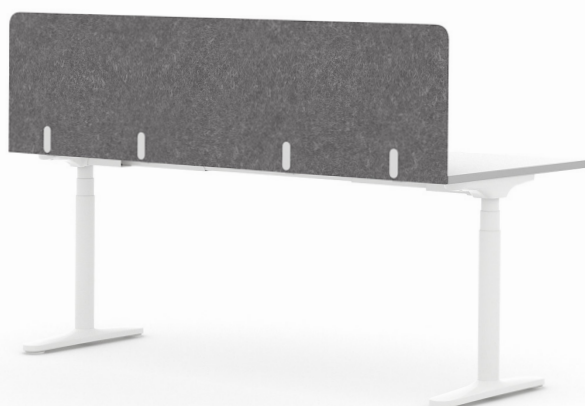

## Worktop Screw-fixed

- Compatible with 18mm, 25mm and 33mm worktops
- Screens can be used as end/return screens for Orbis, Rumba, Kissen, Epic Plus single desks / runs (screen width = 600 – 900mm to match worktop depth)

### Dimensions

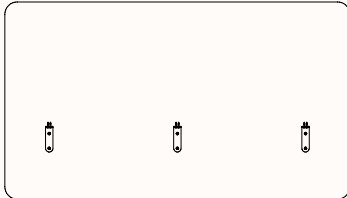

#### Classic Shape

Width Range: 500-2000mm

Screen Actual Height: 205-800mm (depending on worktop thickness)

Worktop rear corner radius: R50

Screen Height Above Desk:

Min: 50mm

Max: 480mm

Screen Height Below Desk:

Min: 130mm

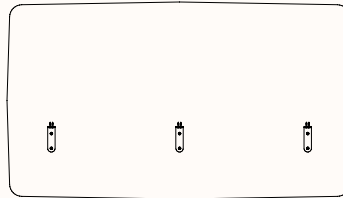

#### Sweep Shape

Width Range: 500-2000mm

Screen Actual Height: 205-800mm (depending on worktop thickness)

Worktop rear corner radius: R50

Screen Height Above Desk:

Min: 50mm

Max: 480mm

Screen Height Below Desk:

Min: 130mm

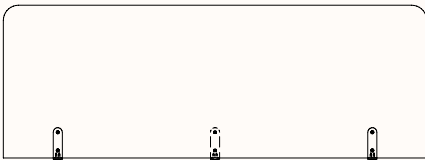

#### Classic Shape

Width Range: 500-2000mm

Screen Actual Height: max 505mm

Worktop rear corner radius: R50

Screen Height Above Desk:

Min: 150mm

Max: 480mm

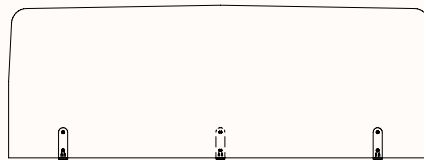

#### Sweep Shape

Width Range: 500-2000mm

Screen Actual Height: max 505mm

Worktop rear corner radius: R50

Screen Height Above Desk:

Min: 150mm

Max: 480mm

## Worktop Screw-fixed

- Compatible with 18mm, 25mm & 33mm worktops
- Classic Shape only
- Compatible with Orbis/Rumba/Kissen 180DEG/Epic Plus 180DEG

## Dimensions

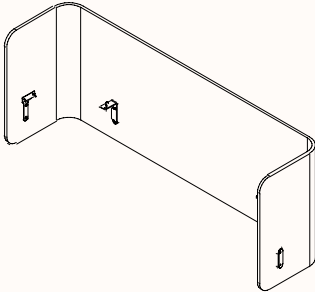

### Curve

Worktop Length Range: 800-2400mm

\*Return Length: 300-800mm

Screen Actual Height: 198mm min (depends on worktop thickness) – 800mm max

Worktop rear corner radius: R50

Screen Height Above Desk:

Min: 50mm

Max: 480mm

Screen Height Below Desk:

Min: 130mm

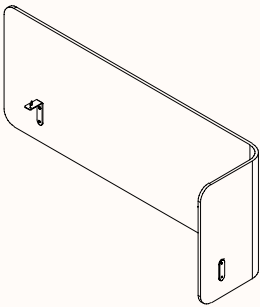

### Curve RH

Worktop Length Range: 800-2400mm

\*Return Length: 300-800mm

Screen Actual Height: 198mm min (depends on worktop thickness) – 800mm max

Worktop rear corner radius: R50

Screen Height Above Desk:

Min: 50mm

Max: 480mm

Screen Height Below Desk:

Min: 130mm

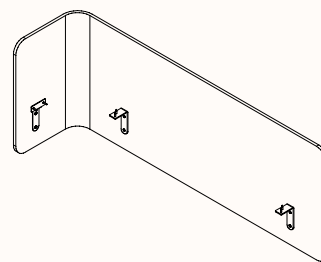

### Curve LH

Worktop Length Range: 800-2400mm

\*Return Length: 300-800mm

Screen Actual Height: 198mm min (depends on worktop thickness) – 800mm max

Worktop rear corner radius: R50

Screen Height Above Desk:

Min: 50mm

Max: 480mm

Screen Height Below Desk:

Min: 130mm

\*Note: Overall screen length limited by substrate

## Worktop Clamp-on

- Compatible with 18mm and 25mm worktops
- Screens can be used as end/return screens for Orbis/Rumba/Kissen/Epic Plus single desks / runs (screen width = 600 – 900mm to match worktop depth)

## Dimensions

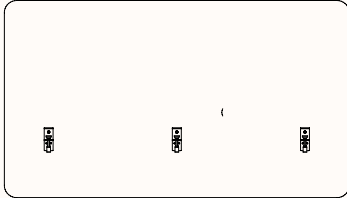

### Classic Shape

Width Range: 500-2000mm

Screen Actual Height: 198-800mm (depending on worktop thickness)

Worktop rear corner radius: R50

Screen Height Above Desk:

Min: 50mm

Max: 480mm

Screen Height Below Desk:

Min: 130mm

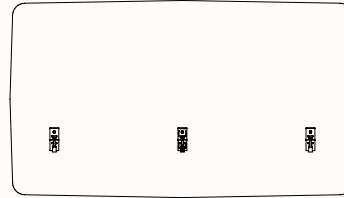

### Sweep Shape

Width Range: 500-2000mm

Screen Actual Height: 198-800mm (depending on worktop thickness)

Worktop rear corner radius: R50

Screen Height Above Desk:

Min: 50mm

Max: 480mm

Screen Height Below Desk:

Min: 130mm